

8

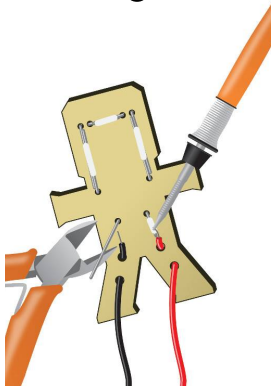

9

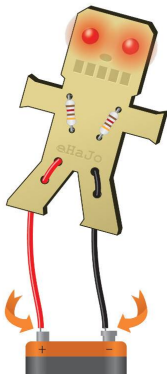

Lötübung Roboter



Elektronik Hannes Jochriem
 Oberfeldweg 12
 D - 83080 Oberaudorf
<http://www.eHaJo.de>

Aufbauanleitung

eHaJo
 Elektronische Bausätze

1

Langes Bein
= Plus
Kurses Bein
= Minus

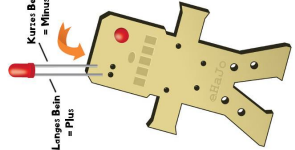

2

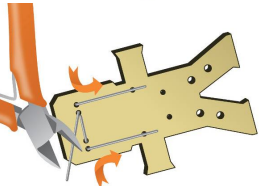

3

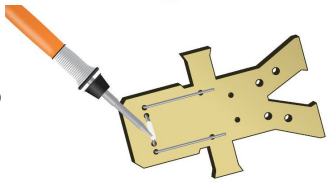

4

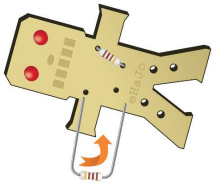

5

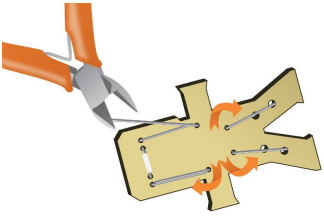

6

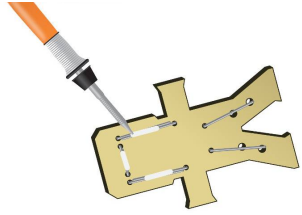

7

